

JERRY GREER'S ENGINEERING © 2020

Brake Assembly – Front

Revised: 10-27-2020

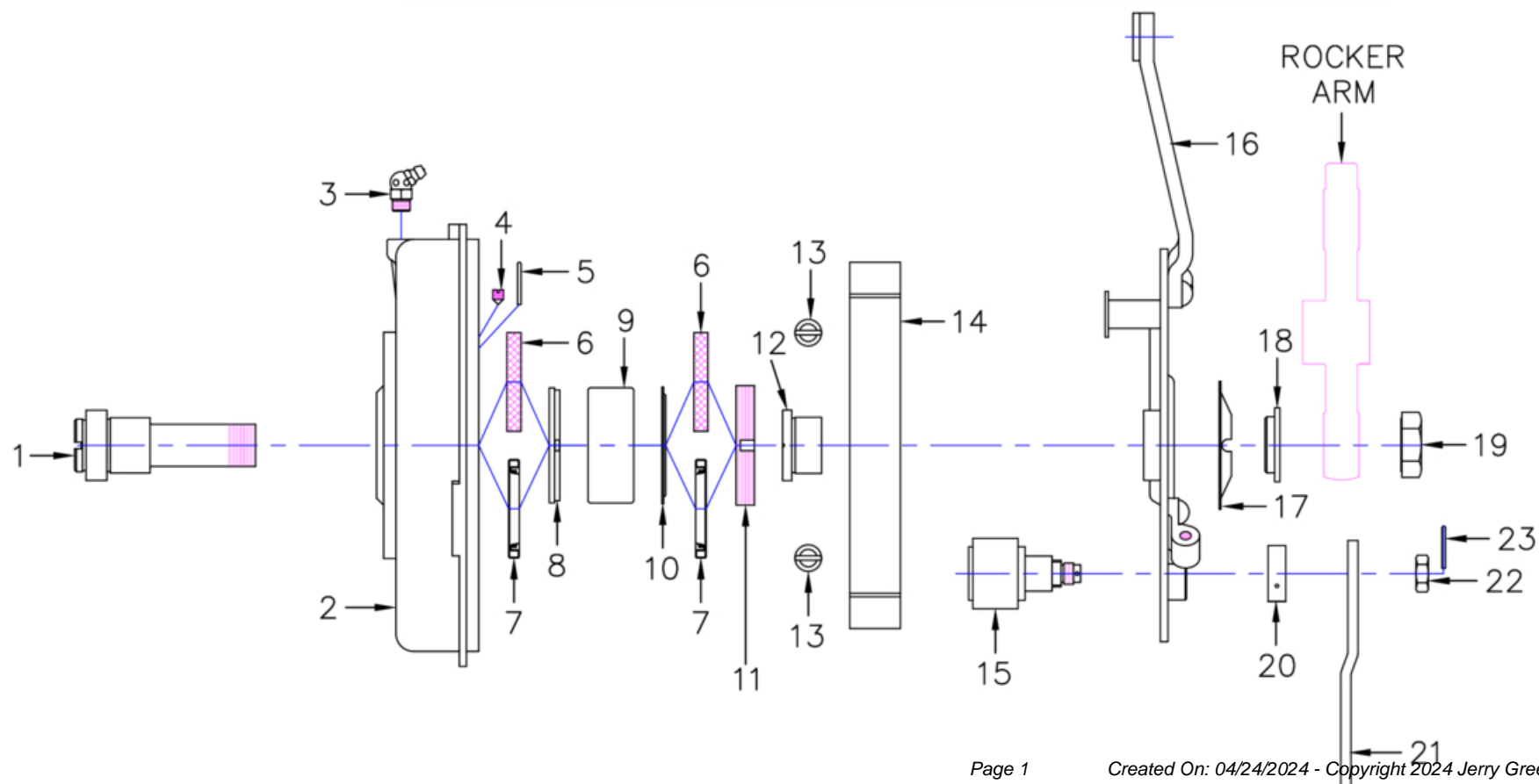
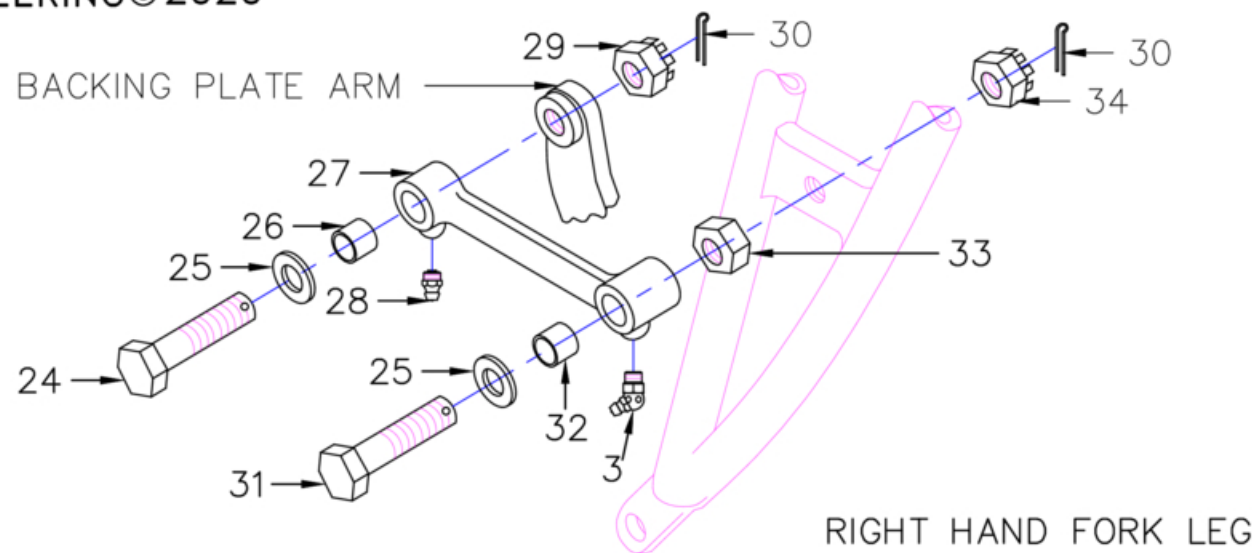

Jerry Greer's Engineering - 1940 Chief - Brake Assembly - Front

Ref	Part #	Qty	Description	Price
1	40848	1	HOLLOW AXLE, 3-1/4"OAL,	\$45.00
2	75029	1	BRAKE DRUM, Made In USA	\$195.00
3	40701	2	GREASE FITTING, 5/16"-32 X .22"; angled; Cad Plated	\$5.75
4	37277	1	SET SCREW, #10-32 X .261" long, pointed, or use cotter pin 636104	\$4.75
5	636104	1	COTTER PIN, 3/32" X 1/2"	\$1.00
6	37605	2	FELT SEAL, 1.750" O.D X .250" thick	\$3.50
7	37605R	2	NEOPRENE SEAL, hollow axle(improvement)	\$14.00
8	40847	1	SPACER, inside brake drum	\$18.00
9	40446	1	BALL BEARING, double row, shielded and lifetime lubricated	\$40.00
10	40843	1	RETAINER, hollow axle seal(Do Not Use with Seal-37605R)	\$5.25
11	37389	1	BEARING NUT, 2.125" O.D standard, LH threads; Cad Plated	\$25.00
12	40849	1	SPACER, brake drum to backing plate	\$18.00
13	36B290	2	BRAKE SHOE SPRING, 2.110" long	\$4.00
14	75068E	1	BRAKE SHOES, reconditioned lining, \$90.00 with approved core exchange	\$140.00
15	41001	1	BRAKE CAM, 1.986" long, square drive	\$80.00
16	75547	1	BRAKE BACKING PLATE, steel; Bare Finish	\$225.00
17	37580	1	SPRING WASHER, brake backing plate, right side	\$18.50
18	37607	1	RETAINER, spring washer; Cad Plated	\$12.50
19	37370	1	HOLLOW AXLE NUT, 3/4"-24 X .360" thick; Cad Plated	\$8.00
20	35B459	1	BRAKE CAM LUBRICATION COVER, .312" thick; Cad Plated	\$8.50
21	42474	1	BRAKE ARM, 4.375" long .095" offset inward, square drive, brake cable routes inside skirted fender	\$20.00
22	605012	1	NUT, 3/8"-24(Jam)	\$1.00
23	636004	1	COTTER PIN, 1/16" X 1/2"	\$0.50
24	45068	1	BOLT, 1/2"-20 X 1.500"(Thin Hex); Cad Plated	\$20.00
25	37617	2	SPRING WASHER, 1/2", for link bolt	\$1.75
26	40995	1	BUSHING, .615" O.D, .742" long, link	\$12.00
27	42463	1	LINK, 4-1/8" hole centers, to backing plate arm, Includes bushings	\$145.00
28	416002	1	GREASE FITTING, 5/16"-32 X .25", straight; Cad Plated	\$3.50

Jerry Greer's Engineering - 1940 Chief - Brake Assembly - Front

Ref	Part #	Qty	Description	Price
29	37434	1	NUT, 1/2"-20(Castle), Thin Hex; Cad Plated	\$8.00
30	636107	2	COTTER PIN, 3/32" X 1"	\$0.50
31	45069	1	BOLT, 1/2"-20 X 2.655"(Thin Hex); Cad Plated	\$28.00
32	42473	1	BUSHING, .615" O.D, .925" long, link	\$14.00
33	37425	1	NUT, 1/2"-20(Hex), counterbore goes against link; Cad Plated	\$11.00
34	603016	1	NUT, 1/2"-20(Castle)	\$6.50