

# JERRY GREER'S ENGINEERING ©2020

Carburetor - Linkert

Revised: 10/20/2020

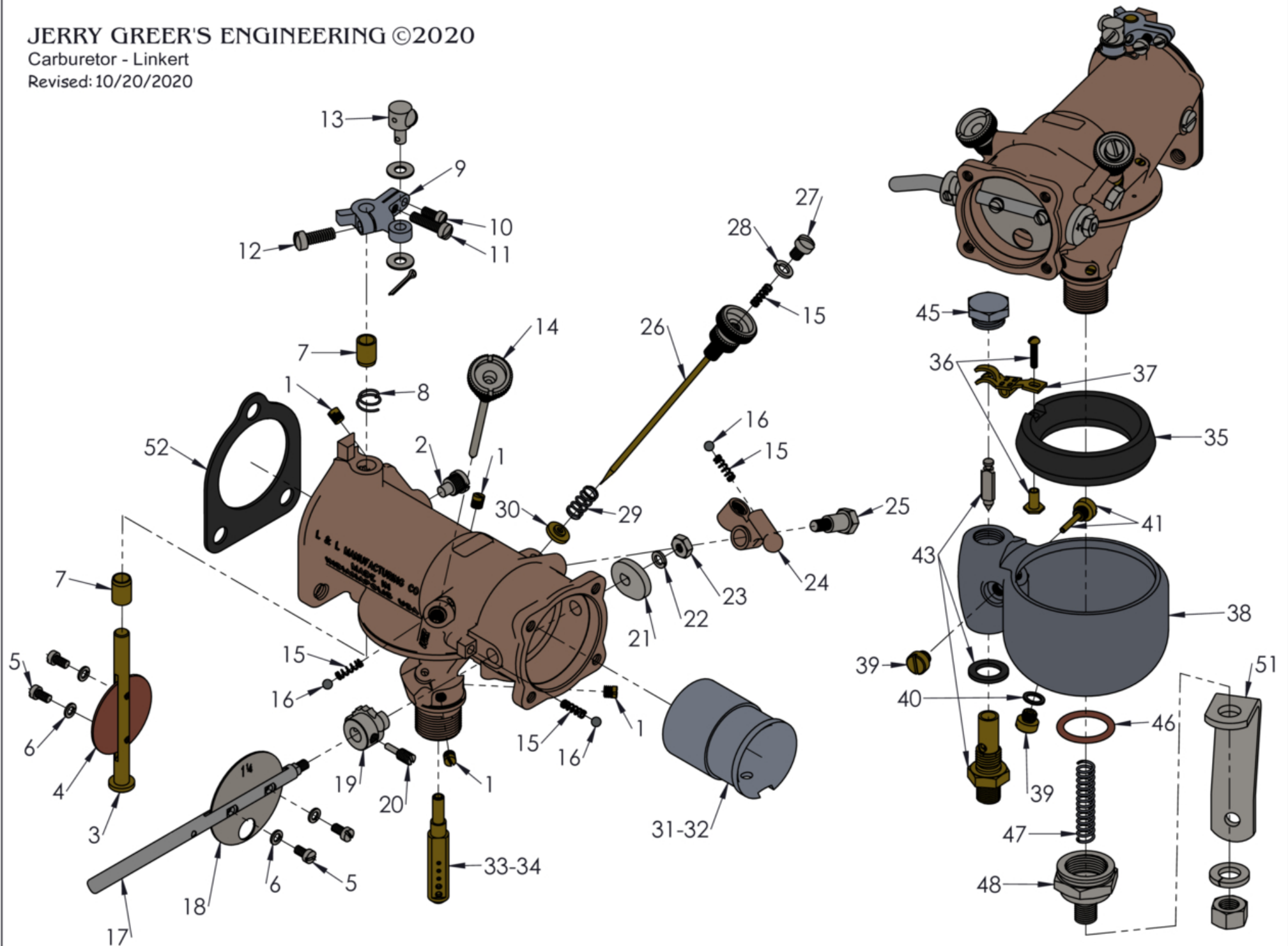

## Jerry Greer's Engineering - 1947 Chief - Carburetor - Linkert

Ref	Part #	Qty	Description	Price
1	102420	4	PLUG, #10-32 X .203" long(Slotted), threaded passages	\$5.00
2	102419	1	PLUG, 5/16"-32 X .462"(Slotted), body idle hole; Cad Plated	\$8.50
3	102426	1	THROTTLE SHAFT,	\$35.00
4	102429	1	THROTTLE DISC,	\$50.00
5	102438	4	SCREW, #6-32 X .250"(Fillister Head), choke and throttle disc, Cad Plated	\$0.75
6	922002	4	WASHER, #6 Split Lock	\$0.50
7	102428	1	THROTTLE SHAFT BUSHING,	\$6.00
8	102427	1	THROTTLE SHAFT SPRING,	\$1.50
9	102432	1	BELL CRANK, throttle shaft assembly, includes hardware	\$60.00
10	102435	1	SCREW, #6-32 X .312"(Fillister Head), Cad Plated	\$0.75
11	102434	1	SCREW, #8-32 X .625"(Fillister Head), Cad Plated	\$2.25
12	102433	1	SCREW, #10-24 X .500"(Fillister Head), Cad Plated	\$1.00
13	JG-2559	1	CABLE SWIVEL ASSEMBLY, for spark and throttle cables, includes all hardware	\$10.75
14	JG-3902	1	HIGH SPEED NEEDLE, ; Cad Plated	\$35.00
15	102445	3	SPRING, friction ball	\$2.75
16	102444	3	BEARING BALL, 5/32" Dia., alloy steel	\$0.50
17	102436	1	CHOKE SHAFT,	\$30.00
18	102437	1	CHOKE DISC,	\$5.50
19	102443	1	CHOKE SHAFT STOP, Cad Plated	\$32.00
20	102446	1	CHOKE SHAFT STOP SCREW, #10-32 X .531" long; Cad Plated	\$6.00
21	102440	1	CHOKE CAM, Cad Plated	\$9.00
22	922003	1	WASHER, #8 Split Lock	\$0.50
23	604003	1	NUT, #8-32(Hex)	\$0.75
24	102462	1	LOW SPEED LIFT LEVER,	\$35.00
25	102463	1	LOW SPEED LIFT LEVER SCREW, Cad Plated	\$6.00
26	JG-3903	1	LOW SPEED NEEDLE, ; Cad Plated	\$50.00
27	751403	1	SCREW, #10-32 X .250"(Fillister Head)	\$1.00
28	922004	1	WASHER, #10 Split Lock; Cad Plated	\$0.75

## Jerry Greer's Engineering - 1947 Chief - Carburetor - Linkert

Ref	Part #	Qty	Description	Price
29	102464	1	LOW SPEED LIFT LEVER SPRING,	\$2.00
30	102629	1	LOW SPEED LIFT LEVER SPRING WASHER, .100" thick	\$15.00
31	102455	1	VENTURI, 1-1/16" use without air passage in carburetor body	\$40.00
32	102456	1	VENTURI, 1-1/8"; Bonneville	\$35.00
33	102628	1	NOZZLE, 2.078" long	\$22.00
34	601002	1	NOZZLE, 2.078" long, Bonneville	\$30.00
35	102447	1	CARBURETOR FLOAT ASSEMBLY, mounting screw included, made from composite material	\$55.00
36	102448	1	CARBURETOR FLOAT SCREW ASSEMBLY, includes screw and nut	\$9.00
37	102450	1	CARBURETOR FLOAT LEVER,	\$45.00
38	102421	1	CARBURETOR BOWL,	\$95.00
39	102422	3	PLUG, 1/4"-32 X .325" long(Slotted), carburetor bowl drain	\$4.00
40	VF2283	1	WASHER, 1/4", .031" thick, Flat, Fiber	\$0.75
41	102452	1	SCREW, includes float lever pin	\$8.00
42	102451	1	CARBURETOR FLOAT LEVER PIN,	\$5.00
43	102716	1	NEEDLE & SEAT, 1/8"-27 NPT, connects to gas line	\$56.00
44	102454	1	GASKET, float seat	\$1.75
45	102425	1	CARBURETOR BOWL PLUG, 9/16"-20 threads	\$10.00
46	102423	1	GASKET, float bowl nut	\$2.50
47	102458	1	NOZZLE RETAINING SPRING,	\$2.00
48	JG-4017	1	BOWL RETAINING NUT, includes washer & nut; Cad Plated	\$18.00
49	922008	1	WASHER, 3/8" Split Lock; Cad Plated	\$0.75
50	606012	1	NUT, 3/8"-24(Hex); Cad Plated	\$0.75
51	28B317	1	CARBURETOR BRACE, ; Cad Plated	\$9.50
52	35B626	1	GASKET, carburetor to manifold	\$2.50
53	JG-2439	1	GASKETS, "Linkert" carburetor	\$10.00
54	JG-2438	1	CARBURETOR REBUILD, "Linkert" includes carburetor float, gaskets and needle & seat with 1/8" NPT threads for gas lines	\$150.00