

JERRY GREER'S ENGINEERING© 2020

Carburetor DLX-130

Revised: 10-29-2020

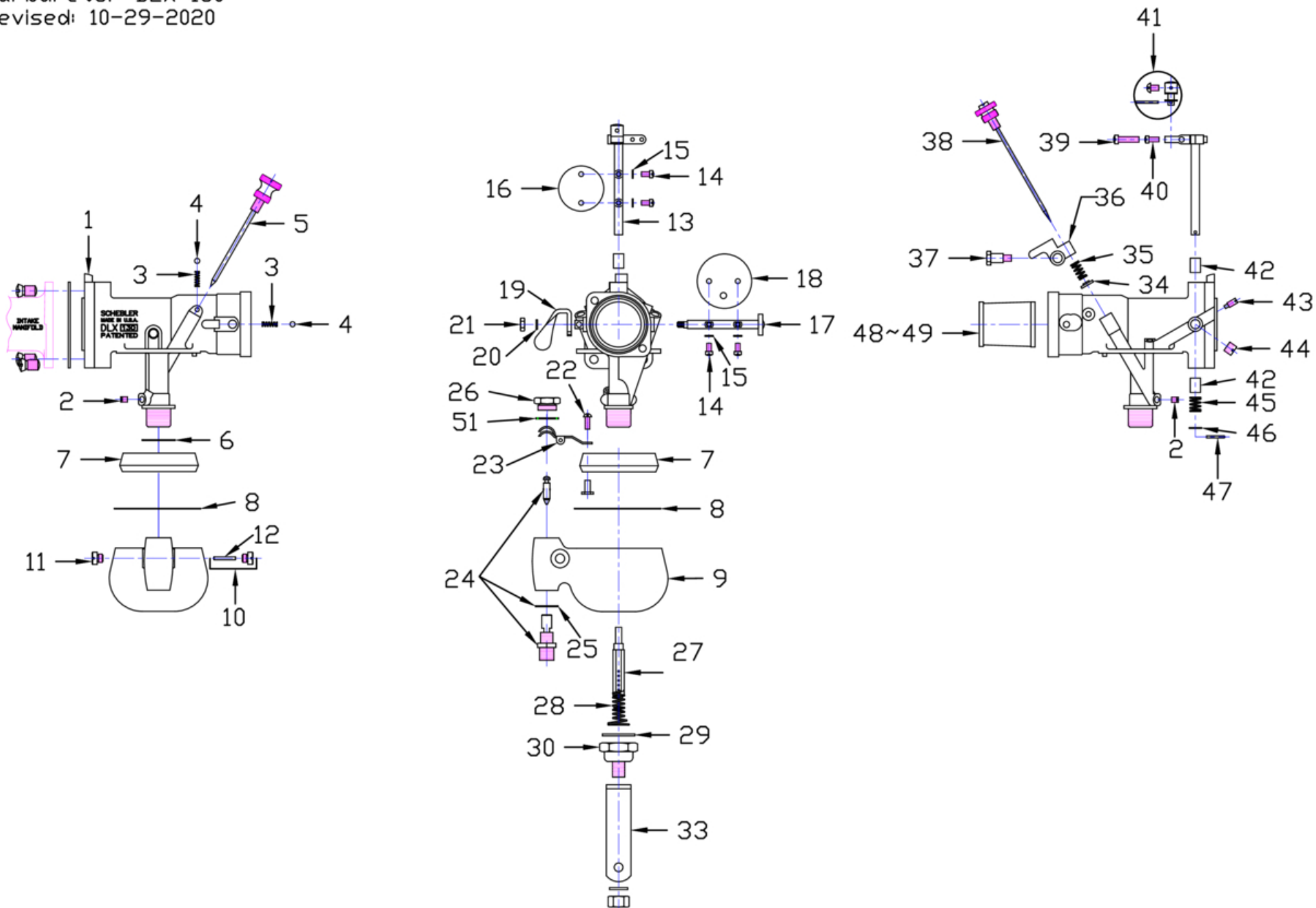

Jerry Greer's Engineering - 1940 Chief - Carburetor DLX-130

Ref	Part #	Qty	Description	Price
1	102194	1	CARBURETOR BODY,	currently unavailable
2	100166	2	BODY DRILL PLUG, #8-32	\$6.00
3	102445	2	SPRING, friction ball	\$2.75
4	102444	2	BEARING BALL, 5/32" Dia., alloy steel	\$0.50
5	100203	1	HIGH SPEED NEEDLE, ; Nickel Plated	\$35.75
6	100590	1	GASKET, carburetor bowl to body stem	\$2.75
7	102447	1	CARBURETOR FLOAT ASSEMBLY, mounting screw included, made from composite material	\$55.00
8	102136	1	GASKET, upper bowl gasket	\$8.00
9	102153	1	CARBURETOR BOWL,	currently unavailable
10	102452	1	SCREW, includes float lever pin	\$8.00
11	102422	1	PLUG, 1/4"-32 X .325" long(Slotted), carburetor bowl drain	\$4.00
12	102451	1	CARBURETOR FLOAT LEVER PIN,	\$5.00
13	100189	1	THROTTLE SHAFT & COLLAR, Cad Plated	\$55.00
14	102438	2	SCREW, #6-32 X .250"(Fillister Head), choke and throttle disc, Cad Plated	\$0.75
15	922002	2	WASHER, #6 Split Lock	\$0.50
16	102429	1	THROTTLE DISC,	\$50.00
17	100192	1	CHOKE SHAFT & CAM, ; Cad Plated	\$45.00
18	100157	1	CHOKE DISC, choke disc	\$5.00
19	101586	1	CHOKE LEVER, ; Nickel Plated	\$28.50
20	922003	1	WASHER, #8 Split Lock	\$0.50
21	604003	1	NUT, #8-32(Hex)	\$0.75
22	102448	1	CARBURETOR FLOAT SCREW ASSEMBLY, includes screw and nut	\$9.00
23	100594	1	CARBURETOR FLOAT LEVER,	\$35.00
24	102162	1	NEEDLE & SEAT, 7/16"-27, .950" long, connects to gas line	\$60.50
25	102454	1	GASKET, float seat	\$1.75
26	102157	1	CARBURETOR BOWL PLUG, 9/16"-24 threads	\$20.00
27	100602	1	NOZZLE, 2.087" long	\$26.00

Jerry Greer's Engineering - 1940 Chief - Carburetor DLX-130

Ref	Part #	Qty	Description	Price
28	102458	1	NOZZLE RETAINING SPRING,	\$2.00
29	102423	1	GASKET, float bowl nut	\$2.50
30	JG-4016	1	BOWL RETAINING NUT, includes washer & nut; Cad Plated	\$23.25
31	922008	1	WASHER, 3/8" Split Lock; Cad Plated	\$0.75
32	606012	1	NUT, 3/8"-24(Hex); Cad Plated	\$0.75
33	28B317	1	CARBURETOR BRACE, ; Cad Plated	\$9.50
34	102629	1	LOW SPEED LIFT LEVER SPRING WASHER, .100" thick	\$15.00
35	102464	1	LOW SPEED LIFT LEVER SPRING,	\$2.00
36	102462	1	LOW SPEED LIFT LEVER,	\$35.00
37	100197	1	LOW SPEED LIFT LEVER SCREW, ; Nickel Plated	\$9.00
38	100201	1	LOW SPEED NEEDLE, ; Nickel Plated	\$35.75
39	101581	1	SCREW, #6-32 X .625"(Fillister Head), Cad Plated	\$1.00
40	101582	1	SCREW, #4-40 X .31"(Fillister Head), Cad Plated	\$1.00
41	JG-2559	1	CABLE SWIVEL ASSEMBLY, for spark and throttle cables, includes all hardware	\$10.75
42	102428	1	THROTTLE SHAFT BUSHING,	\$6.00
43	100167	1	IDLE PASSAGE PLUG SCREW,	\$5.50
44	100970	1	PLUG, 5/16"-24 X .247"(Slotted); Cad Plated	\$7.00
45	100156	1	SPRING, throttle shaft friction(tension) spring	\$5.00
46	100159	1	TENSION WASHER, throttle shaft friction tension spring washer	\$4.75
47	636004	1	COTTER PIN, 1/16" X 1/2"	\$0.50
48	102201	1	VENTURI, 1-1/16", use with air passage in carburetor body	\$33.00
49	102455	1	VENTURI, 1-1/16" use without air passage in carburetor body	\$40.00
50	JG-3473	1	CARBURETOR BOWL REPAIR, complete kit to repair bowl threads	\$15.00
51	102134	1	GASKET, carburetor bowl plug	\$9.50