

TRANSMISSION CASE
WITH SPROCKET
ON SHAFT

SHIFTER ROD
BELL-CRANK
SHAFT

SEAT POST AND
KICKSTARTER CRANK
STUD HOUSING ON
MOTORCYCLE FRAME

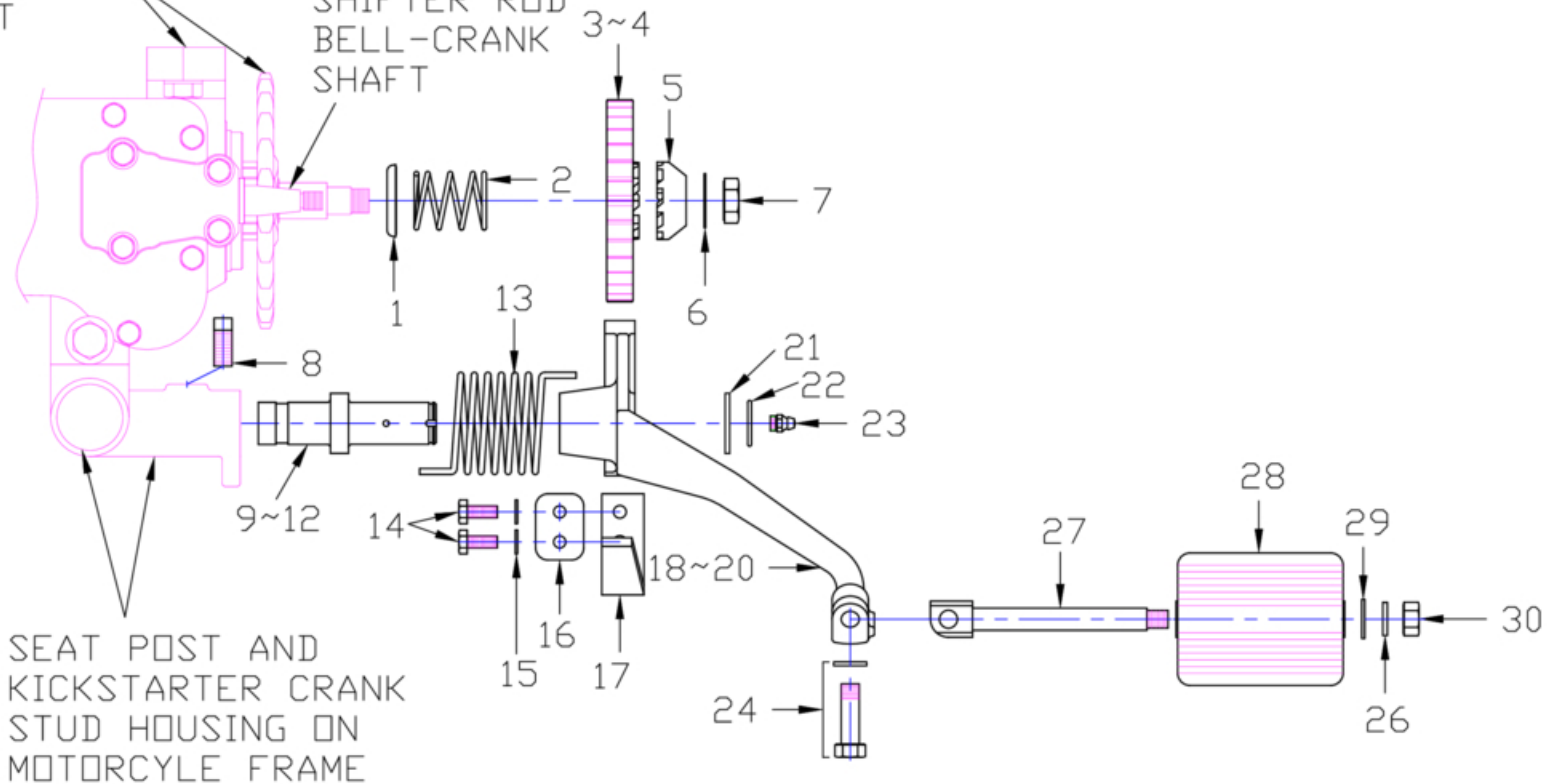

Jerry Greer's Engineering - 1940 Chief - Kick Starter

Ref	Part #	Qty	Description	Price
1	19B46	1	WASHER, cupped, pinion gear spring; Cad Plated	\$8.00
2	19B47	1	KICK STARTER PINION GEAR SPRING,	\$5.00
3	44286	1	KICK STARTER PINION GEAR, 32 teeth, ratchet style, distributor model, use with 41828	\$125.00
4	41827	1	KICK STARTER PINION GEAR, 28 tooth, ratchet style, magneto model, "Bonneville", use with 41828	currently unavailable
5	41828	1	KICK STARTER PINION CLUTCH, 1.5" O.D., 10 tooth	\$85.00
6	20B398	1	KICK STARTER PINION CLUTCH WASHER, ; Cad Plated	\$3.50
7	A25280	1	NUT, 1/2"-24(Hex); Cad Plated	\$4.50
8	45109	1	SET SCREW, 3/8"-16 X .750"(Square Head); Cad Plated	\$2.00
9	39933	1	KICK STARTER CRANK STUD, .876" Dia. (Standard) 3.69" long	\$45.00
10	39933-U	1	KICK STARTER CRANK STUD, .886" Dia. (.010 oversize) 3.69" long, oversize end goes into frame	\$50.00
11	39933-V	1	KICK STARTER CRANK STUD, .896" Dia. (.020 oversize) 3.69" long, oversize end goes into frame	\$50.00
12	39933-W	1	KICK STARTER CRANK STUD, .906" Dia. (.030 oversize) 3.69" long, oversize end goes into frame	\$50.00
13	40277	1	KICK STARTER CRANK SPRING,	\$11.75
14	207009	2	BOLT, 1/4"-28 X .625"(Hex)	\$2.75
15	922006	2	WASHER, 1/4" Split Lock; Cad Plated	\$0.75
16	20B328	1	KICK STARTER CRANK STOP REINFORCEMENT, ; Cad Plated	\$4.75
17	827004	1	KICK STARTER CRANK STOP, ; Cad Plated	\$30.00
18	76234	1	KICK STARTER CRANK, 10 tooth, distributor model; Cad Plated	\$395.00
19	75544	1	KICK STARTER CRANK, 11 tooth, magneto model; Bare Finish	currently unavailable
20	743004	1	KICK STARTER CRANK, 12 tooth, longer arm to make kick starting easier; Cad Plated	\$325.00
21	37576	1	KICK STARTER LOCK RING WASHER, .886" I.D. X .128" thick; Cad Plated	\$5.00
22	39934	1	KICK STARTER CRANK LOCK RING, .750" I.D; Cad Plated	\$5.00
23	416002	1	GREASE FITTING, 5/16"-32 X .25", straight; Cad Plated	\$3.50
24	JG-2502	1	FASTENER, Kick Starter pedal	\$3.25
25	37252	1	BOLT, 3/8"-24 X 1.250"(Hex), pedal to crank arm; Cad Plated	\$3.00
26	922008	2	WASHER, 3/8" Split Lock; Cad Plated	\$0.75
27	39423	1	KICK STARTER PEDAL PIN, 3/8"-24, 4.057" long; Cad Plated	\$34.00

Jerry Greer's Engineering - 1940 Chief - Kick Starter

Ref	Part #	Qty	Description	Price
28	75572	1	KICK STARTER PEDAL, rubber	\$30.00
29	920008	1	WASHER, 3/8" Flat; Cad Plated	\$0.50
30	606012	1	NUT, 3/8"-24(Hex); Cad Plated	\$0.75