

VIEW OF BRUSH ASSEMBLY  
INSTALLED ON END PLATE  
2 X SCALE

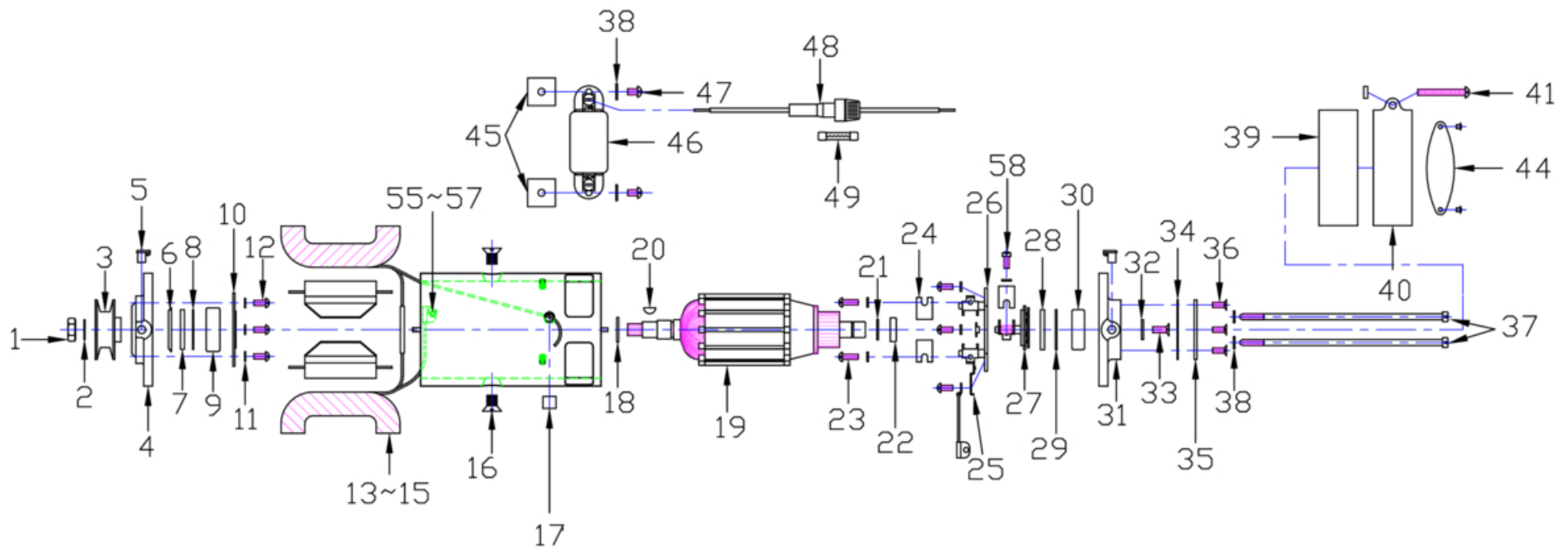

## Jerry Greer's Engineering - 1940 Chief - Generator

Ref	Part #	Qty	Description	Price
1	605014	1	NUT, 7/16"-20(Jam)	\$2.75
2	100224	1	WASHER, 7/16", External Tooth Lock Washer; Zinc Plated	\$0.75
3	40877	1	GENERATOR PULLEY, 1-7/8" O.D.; Cad plated	\$35.00
4	100250	1	DRIVE END HEAD ASSEMBLY	currently unavailable
5	100234	1	OILER, hinge top, press-in, sold as pair	\$28.00
6	100251	1	RETAINER, generator drive end bearing	\$12.00
7	100230	1	FELT SEAL, drive end bearing, use stock pulley	\$1.50
8	100231	1	RETAINER, felt washer	\$4.00
9	100229	1	DRIVE END HEAD BEARING, sealed	\$10.00
10	JG-3060	1	RETAINER PLATE, bearing retainer plate	\$18.50
11	922003	9	WASHER, #8 Split Lock	\$0.50
12	754205	6	SCREW, #8-32 X .375"(Slotted Round Head)	\$1.00
13	101971	1	FIELD COILS, 6-Volt, high output, left and right fields, use with voltage regulator	\$175.00
14	100262	1	FIELD COILS, 6-Volt, standard output, left and right fields, use with cutout relay	\$175.00
15	JG-3570	1	FIELD COILS, 12-Volt, standard output, left and right fields, use with original generator	\$175.00
16	102540	2	SCREW, 3/8"-16 X 0.553"(Flat Head), Cad Plated	\$7.50
17	102190	1	BUSHING, insulating, main brush, lead, (standard), for cutout equipped generator	\$5.50
18	100222	1	SNAP-RING, drive end	\$4.00
19	101976	1	ARMATURE, standard, auto-lite, (PN GAS2076), Rebuilt	\$230.00
20	100225	1	KEY, 3/32 X 3/8(Woodruff)	\$0.75
21	100221	1	SNAP-RING, commutator end	\$6.00
22	100228	1	RETAINER, cupped, for commutator end snap ring	\$9.00
23	754207	2	SCREW, #8-32 X .500"(Round Head)	\$1.25
24	102547	1	BRUSH SET, (includes 2 P/N 100241 main & 1 P/N 100248 third)	\$15.00
25	100425	2	THIRD BRUSH PLATE SPRING, retaining	\$3.75
26	101979	1	MAIN BRUSH HOLDER PLATE ASSEMBLY, includes ground wire, brushes not included	currently unavailable
27	102199	1	THIRD BRUSH HOLDER PLATE ASSEMBLY,	\$30.00

## Jerry Greer's Engineering - 1940 Chief - Generator

Ref	Part #	Qty	Description	Price
28	100227	1	FELT SEAL, .625" I.D X .187" thick, commutator end bearing	\$2.00
29	102292	1	COMMUTATOR END BEARING WASHER	\$4.00
30	100226	1	COMMUTATOR END BEARING, sealed	\$18.50
31	102196	1	COMMUTATOR END PLATE	currently unavailable
32	100236	1	COMMUTATOR END BEARING RETAINER WASHER,	\$6.75
33	100237	1	SCREW, #10-32 X .437"(Flat Head); Zinc Plated	\$1.00
34	100235	1	GASKET, commutator end cover	\$3.00
35	101220	1	COMMUTATOR END COVER PLATE, ; Cad Plated	\$10.00
36	100423	3	SCREW, #8-32 X .375"(Flat Head), Cad Plated	\$0.75
37	100206	2	SCREW, #10-32 X 6.39"(Slotted Pan Head), Cad Plated	\$14.50
38	922004	4	WASHER, #10 Split Lock; Cad Plated	\$0.75
39	JG-2423	1	GASKET, generator band	\$3.00
40	102975	1	GENERATOR BAND, 3.688 " O.D X 1.188" thick; Bare Finish	\$28.00
41	JG-2429	1	FASTENERS, generator band	\$1.50
42	102545	1	SCREW, #10-32 X 1.500"(Round Head), Cad Plated	\$1.00
43	100634	1	NUT, #10-32(Square), Cad Plated	\$0.75
44	JG-2190	1	GENERATOR TAG, "Autolite", with rivets, "stamp your own numbers"	\$14.50
45	102543	2	CUT-OUT RELAY SPACER, 0.060" Thick,Cad Plated	\$4.75
46	100252	1	CUT-OUT RELAY, JGE manufactured replacement, Made in USA	\$275.00
47	754404	2	SCREW, #10-32 X .312"(Round Head)	\$1.00
48	JG-1186	1	FUSE HOLDER, in line, includes(AGC 6 Amp fuse), for external field ground, upgrade for cut-out relay equipped generators	\$12.00
49	JG-3261	A/R	FUSE, AGC-20 Amp, for in line fuse holder	\$1.00
50	JG-3341	A/R	REGULATOR, 12-Volt, built in regulator for aftermarket cycle electric generator	\$160.00
51	JG-4349	1	GENERATOR, 6-Volt built in regulator, for aftermarket cycle electric voltage regulator, fits stock mounting clamp	\$575.00
52	JG-3134	1	GENERATOR, 12-Volt built in regulator, for aftermarket cycle electric voltage regulator, fits stock mounting clamp	\$550.00
53	JG-4078	1	GENERATOR, 12-Volt without regulator, for aftermarket cycle electric voltage regulator, fits stock mounting clamp	\$450.00
54	JG-4079	1	REGULATOR, 12-Volt	\$130.00

Jerry Greer's Engineering - 1940 Chief - Generator				
Ref	Part #	Qty	Description	Price
55	750106	1	SCREW, #6-32 X .438"(Round Head)	\$0.50
56	100246	1	WASHER, #8 internal tooth lock washer; Cad Plated	\$0.50
57	JG-2993	1	NUT, #6-32(Hex)	\$0.75
58	JG-5011	1	SCREW, #8-32 X .375"(Fillister Head)	\$1.00
59	JG-5391	1	GENERATOR BRUSH SET,	\$14.00