

# JERRY GREER'S ENGINEERING

Fork - Leaf Spring  
Revised: 1/27/2022

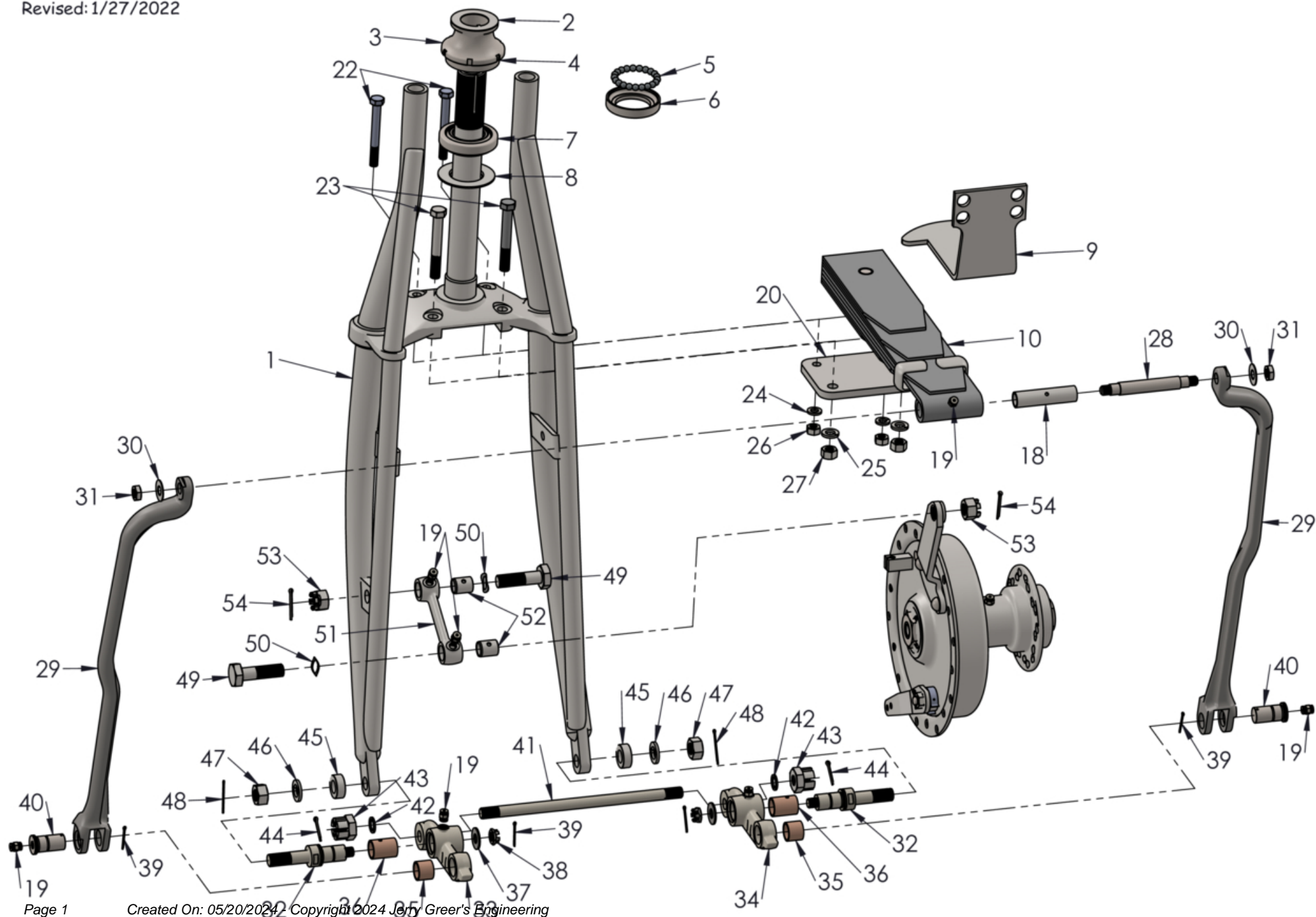

## Jerry Greer's Engineering - 1936 Indian Four - Fork - Leaf Spring

Ref	Part #	Qty	Description	Price
1	74691	1	LEAF SPRING FORK,	currently unavailable
2	37508	1	WASHER, 1" internal tab, upper steering head bearing; Cad Plated	\$5.00
3	42742	1	ADJUSTING CONE, upper steering head bearing, (for loose ball bearings)	\$90.00
4	JG-2525	1	BALL BEARING, upper steering head, improvement, replaces bearing ball and cup, machining required	\$16.75
5	C18120	1	BEARING BALLS, 1/4" Dia., upper steering head bearing, (package of 21)	\$6.50
6	42744	1	CUP, upper steering head bearing, (for loose ball bearings)	\$55.00
7	38854	1	BEARING, lower steering head, tapered (improvement)	\$85.00
8	37504	1	DUST SHIELD/SPACER, lower steering head bearing; Cad Plated	\$13.00
9	74169	1	HORN BRACKET, ; Bare Finish	\$24.00
10	JG-3701	1	LEAF SPRING, fork leaf spring, includes bushing (100477)	\$395.00
11	JG-3694	2	SPRING LEAF, 6.923 X 2.5 X .122	\$38.00
12	JG-3695	2	SPRING LEAF, 9.156 X 2.5 X .122	\$42.00
13	JG-3696	1	SPRING LEAF, 11.941 X 2.5 X .122	\$48.00
14	JG-3697	1	SPRING LEAF, 12.700 X 2.5 X .182	\$100.00
15	JG-3698	1	SPRING LEAF, 11.411 X 2.5 X .182	\$50.00
16	JG-3699	1	SPRING LEAF, 10.456 X 2.5 X .180, includes clip and rivet	\$130.00
17	102055	1	RIVET, 5/16" O.D X 2.500(Countersunk Head)	\$1.00
18	100477	1	BUSHING, leaf spring eye, steel	\$9.50
19	26B242X	5	GREASE FITTING, 5/16"-32 X .15"; straight button head; Nickel Plated	\$4.00
20	38347	1	LEAF SPRING FORK PLATE, 1/4"; Bare Finish	\$14.50
21	JG-2535	1	FASTENERS, leaf springs to fork	\$22.00
22	37209	2	BOLT, 5/16"-24 X 2.750"(Hex)	\$5.00
23	207227	2	BOLT, 3/8"-24 X 2.750"(Hex)	\$4.50
24	922007	2	WASHER, 5/16" Split Lock; Cad Plated	\$0.75
25	922008	2	WASHER, 3/8" Split Lock; Cad Plated	\$0.75
26	606010	2	NUT, 5/16"-24(Hex); Cad Plated	\$1.25
27	606012	2	NUT, 3/8"-24(Hex); Cad Plated	\$0.75

## Jerry Greer's Engineering - 1936 Indian Four - Fork - Leaf Spring

Ref	Part #	Qty	Description	Price
28	39942	1	LEAF SPRING CONNECTING LINK STUD, 3/8"-24 X 4.010" long; Cad Plated	\$40.00
29	74114	2	LEAF SPRING CONNECTING LINK, can only be purchased as a match set(QTY 2)	\$325.00
30	37579	2	LEAF SPRING CONNECTING LINK STUD WASHER, .853"O.D, .030" thick, Flat; Cad Plated	\$1.00
31	37342	2	NUT, 3/8"-24(Hex), 5/8 Flats	\$2.25
32	25B307	2	ROCKER ARM STUD, open fender models only, Wrench part # JG-3587; Nickel Plated	\$48.00
33	38628	1	ROCKER ARM, right, includes bushings and grease fitting	\$200.00
34	38630	1	ROCKER ARM, left, includes bushings and grease fitting	\$200.00
35	24B150	2	BUSHING, rocker arm front hole, bronze	\$7.00
36	42167	2	BUSHING, rocker arm center hole, bronze	\$8.00
37	20B163	2	WASHER, 3/8" Flat; Nickel Plated	\$5.25
38	20B164	2	NUT, 3/8"-24(Castle); Nickel Plated	\$10.00
39	636006	4	COTTER PIN, 1/16" X 3/4"	\$0.50
40	27B52	2	PIN, pivot for rocker arm front hole; Cad Plated	\$25.00
41	43771	1	CENTER AXLE, 7/16"-20 X 8.97" long, recommend replacing hollow axle to insure proper fit; Cad Plated	\$22.00
42	JG-3181	2	FLAT WASHER, .469" I.D, .060" Thick; Cad Plated	\$3.25
43	JG-4722	2	CENTER AXLE NUT, 7/16"-20; Nickel Plated	\$10.00
44	636105	2	COTTER PIN, 3/32" X 5/8"	\$0.50
45	22B177	2	ROCKER ARM STUD SPACER, .519" I.D, .349" thick; Cad Plated	\$8.50
46	922010	2	WASHER, 1/2" Split Lock; Cad Plated	\$0.75
47	606016	2	NUT, 1/2"-20(Hex); Cad Plated	\$4.75
48	37716	2	COTTER PIN, 3/32" X 1"	\$0.50
49	37204	2	BOLT, 1/2"-20 X 1.781"(Hex)link; Cad Plated	\$16.25
50	37617	2	SPRING WASHER, 1/2", for link bolt	\$1.75
51	38467	1	LINK, 3" on center, to backing plate arm, includes bushing	\$250.00
52	40995	2	BUSHING, .615" O.D, .742" long, link	\$12.00
53	603016	2	NUT, 1/2"-20(Castle)	\$6.50
54	636107	2	COTTER PIN, 3/32" X 1"	\$0.50