

JERRY GREER'S ENGINEERING © 2020

Fender - Front
Revised: 11-09-2020

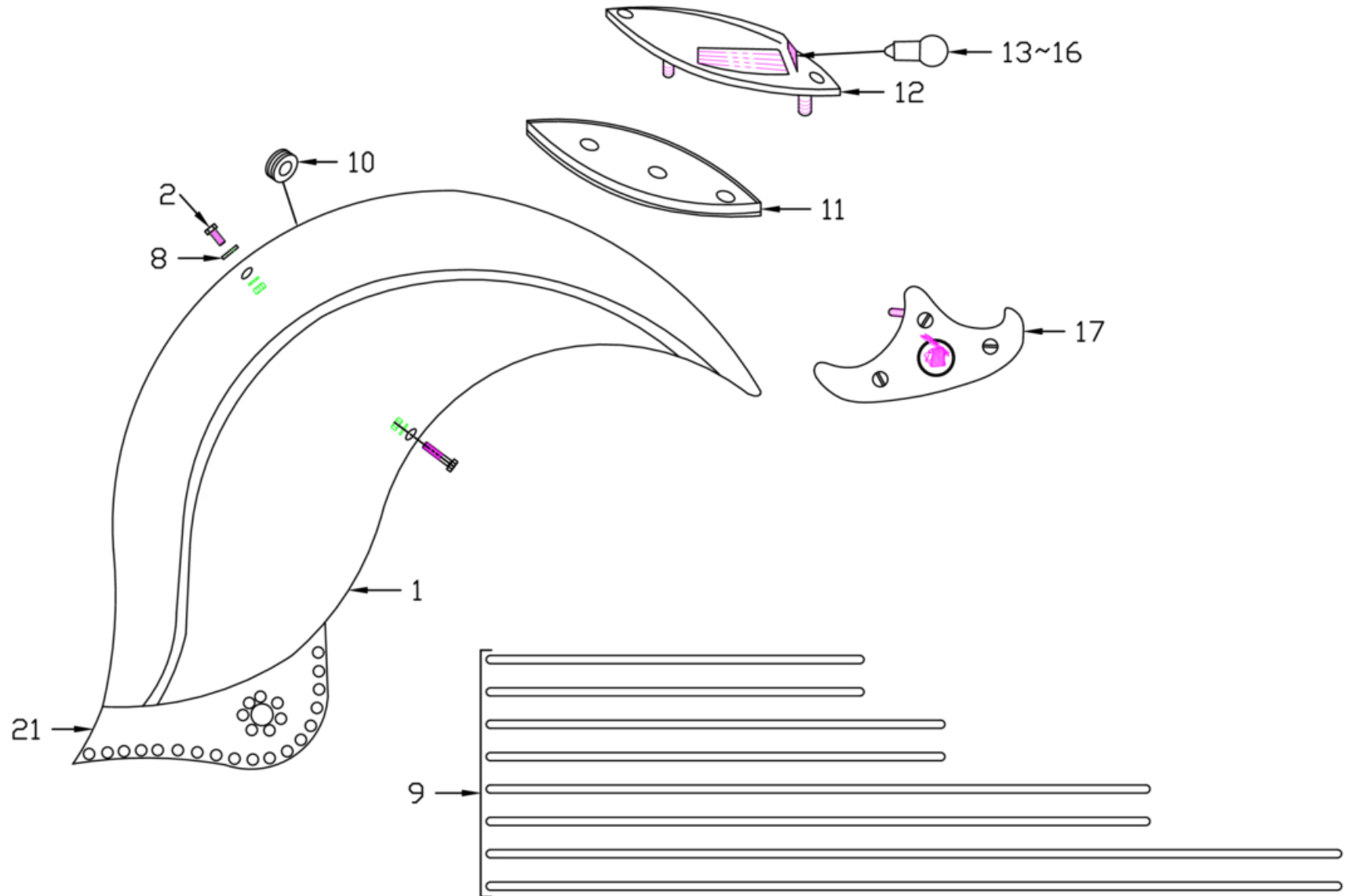

Jerry Greer's Engineering - 1940 Chief - Fender - Front

Ref	Part #	Qty	Description	Price
1	93082	1	FRONT FENDER, without mounting holes; Bare Finish	currently unavailable
2	JG-2651	1	FASTENERS, front fender mounting	\$18.00
3	207113	2	BOLT, 5/16"-24 X 1"(Hex)	\$3.00
4	207117	2	BOLT, 5/16"-24 X 1.500"(Hex)	\$4.75
5	920007	4	WASHER, 5/16" Flat; Cad Plated	\$0.75
6	922007	4	WASHER, 5/16" Split Lock; Cad Plated	\$0.75
7	606010	4	NUT, 5/16"-24(Hex); Cad Plated	\$1.25
8	37656	2	FRONT FENDER SPACER, .343" I.D, .135" thick; Cad Plated	\$4.50
9	JG-3151	1	TOP & SIDE TRIM, mounting hardware included	\$230.00
10	42166	1	GROMMET, tail light wire	\$1.50
11	101757	1	FRONT FENDER MOUNTING PAD, foam	\$4.50
12	101807	1	FRONT FENDER LIGHT, Streamlined style, mounting pad and mounting hardware included; Chrome Plated	\$120.00
13	102507	1	BULB, 6-Volt, parallel pins, .594" Diameter base	\$2.25
14	JG-4304	1	BULB, 12-Volt, parallel pins, .59" diameter base	\$2.25
15	JG-2662	1	BULB, 6-Volt, parallel pins, .36" Diameter base	\$2.25
16	JG-3229	1	BULB, 12-Volt, parallel pins, .36" diameter base	\$2.25
17	160024	1	FRONT FENDER TIP, Indian head dress logo, mounting hardware included; Chrome Plated	\$80.00
18	JG-3353	3	SCREW, #8-32 X 0.750" (Oval Head)	\$0.50
19	922003	3	WASHER, #8 Split Lock	\$0.50
20	604003	3	NUT, #8-32(Hex)	\$0.75
21	160020	1	MUD FLAP, black leather, 60 Nickel Plated spots and 3 sets of round spot patterns, includes fastener kit JG-2906	\$140.00
22	JG-2906	1	FASTENERS, mud flap mounting, used with 160019 & 160020	\$12.25
23	754407	5	SCREW, #10-32 X .500"(Round Head); Cad Plated	\$0.75
24	920003	5	WASHER, #8 Flat; Cad Plated	\$0.75
25	922004	5	WASHER, #10 Split Lock; Cad Plated	\$0.75
26	604005	5	NUT, #10-32(Hex)Cad Plated	\$0.50